



Dynabrade Air Powered Portable Vacuum System



Operating Instructions for Dynabrade P/N 64625

AIR POWERED PORTABLE VACUUM SYSTEM

The 64625 Air Powered Portable Vacuum System has been developed as a safe, portable, mobile, yet powerful industrial tool for commercial use particularly where use of electric equipment is hazardous or where electric supply is not available. To ensure that this quality equipment is properly used and maintained to its full capability, please carefully read the following safety instructions and operating procedures before commencement of the operation.

***Contact our Customer Service Department
at 1-800-828-7333 for any questions or
service requirements.***

IMPORTANT SAFETY INSTRUCTIONS

***When operating this equipment, basic precautions should always be followed
including the instructions listed below:***

- 1.** Do not use the unit to pick up any type of liquid or wet material as it will clog the filter and possibly cause damage to the machine.
- 2.** Do not use the unit as a vacuum cleaner. Use only with pneumatic power tools that have vacuum-ready capability.
- 3.** Do not leave the unit unattended when connected to a high pressure air supply. Disconnect the air supply when not in use and before servicing.
- 4.** Do not allow use of the unit as a toy. Close attention is necessary when used by or near children.
- 5.** Use only as described in this manual. Use only attachments recommended by Dynabrade, Inc.
- 6.** If the unit is not working as it should, or it has been dropped, damaged, or left outdoors, contact us for service instructions.
- 7.** Do not pull or carry unit by the air supply hose or power cord. Do not pull air supply hose around sharp edges or corners. Keep the power cord away from heated surfaces.
- 8.** Do not put any object into openings or use the unit with an opening blocked. Keep the openings free of dust, lint, hair and anything that may reduce air flow.
- 9.** Do not pick up anything that is burning or smoking, such as cigarettes, matches, or hot ashes.
- 10.** Keep hair, loose clothing, fingers and all parts of body away from openings and moving parts.
- 11.** Do not use without dust bag (Part No. 64627, 12/pkg.) and/or filter (Part No. 64626) in place.
- 12.** Turn off air on/off switch before disconnecting the air supply hose.
- 13.** Do not use to pick up flammable or combustible liquids such as gasoline or use in areas where they may be present.
- 14.** When not in use, do not store the unit outdoors.

GROUNDING INSTRUCTIONS

Although this unit is air operated, this unit must be grounded to avoid any static electric build-up. If it should malfunction or breakdown, grounding provides a path of least resistance for electric current to reduce the risk of electric shock.

Where it is critical to avoid shocks or sparks caused by static electricity, an electrically conductive and grounded air supply hose must be used.

WARNING

Grounding by means of a ground wire is provided between both ends of the air supply tubing passing through vacuum hose.

ASSEMBLY INSTRUCTIONS

Refer to the drawing and parts list on the back page for the name and location of parts mentioned in this section.

1. While opening the carton, carefully inspect outside of the carton for any sign of transportation damage, and if so, notify your shipper immediately.
2. Open carton and remove hoses, hose connectors and other accessories.
3. Lay carton on its back and wheel the unit out. The wheels are already installed.
4. Remove all packing, release the two rim clamps on the unit and remove vacuum head assembly to make sure no packing materials are left inside the unit.
5. Check to make sure the filter is seated firmly. If not, tighten round cap nut at base of filter unit.
6. The handle is installed at the factory for most models. If not, it is packed separately. Install the handle to the unit with four sets of supplied screws and nuts.
7. Remove the vacuum hose assembly from bag. Two complete sets are included with Model 64625. Note that the air supply tube (the smaller of the two) protrudes at both ends and is longer than the vacuum hose.
8. Connect quick coupler male end to air outlets located on vacuum head assembly.
9. Install female quick coupler (not supplied) to 1/4" NPT male threads provided at the other end of air hose. Install a compatible male quick coupler (not supplied) to air tools to enable easy changing of air tools.
10. Lift vacuum inlet covers and insert vacuum hoses.
11. Connect air supply to air inlet fitting (1/4" NPT female threads) located at the back side of vacuum head. Air pressure should be adjusted according to the pressure requirement of the air tools you are using. Do not exceed 150 PSIG (10.3 kg/cm²). Some pressure drop is unavoidable between the main air supply and the air tools due to internal flow resistance in a long air hose.
Air pressure of 20 to 30 PSIG (1.4 to 2.0 kg/cm²) higher than the air pressure specified for the air tool being used is recommended.
The installation of a Dynabrade Filter-Regulator-Lubricator (FRL Part No. 11411) is highly recommended to protect the unit and the air tools.
Where it is critical to avoid shocks or sparks caused by static electricity, air supply hose which is electrically conductive and ground must be used.
12. The Dynabrade Model 64625 comes with a set of five dust bags. Install bag inside main body (bottom portion) and fold the bag top over the edge of the base container. Make sure that vacuum balance tube (square tube) protrudes through a hole in the bag.
13. Order dust bags (Part No. 64627) before you run out of them.
14. Return vacuum head to the unit and lock the two rim clamps to secure vacuum head in position.
15. Connect your Dynabrade air tool or accessory and you are now ready for working with the Dynabrade Air-Powered Portable Vacuum System.

CAUTION

THIS IS A PRECISION PIECE OF EQUIPMENT designed for dust extraction to keep your ENVIRONMENT and your REPUTATION "DUST-FREE." Read operating instructions before using Dynabrade Air-Powered Portable Vacuum System and be thoroughly conversant with safety precautions in your locality.

OPERATING INSTRUCTIONS

The following items should be well-noted for the effective use of the unit.

1. Always wear safety glasses and any other safety items required by law.
2. The vacuum system will operate by an on/off switch located on vacuum head assembly. This switch must be turned on and off manually.
3. The top of the vacuum head of Dynabrade Model 64625 is designed to work as shelf to hold air tools, sandpaper, etc.
4. The filter element used inside Dynabrade Model 64625 is water resistant and washable. In order to prevent damage, do not use high pressure or solvent to wash the filter.

OPERATING TIPS AND TROUBLESHOOTING

Keep machine clean to ensure optimum performance. After each use, lift off vacuum head and knock dust from filter. After one hour of continuous use, lift out the vacuum head and check the amount of dust accumulated in the unit. Remove the dust bag if necessary and replace with a new one. We recommend a soft brush to clean the filter. **DO NOT USE A BLOW GUN.**

Decrease in Vacuum Performance

1. Clean the filter thoroughly and as often as necessary. The filter used inside Model 64625 is water resistant and washable. To prevent damage, do not use high pressure or solvent to wash the filter.
2. If the filter (P/N 64626) should become damaged or badly clogged and cannot be cleaned, replace with a new one.
3. Check all the vacuum lines for blockage or leakage.

⚠ CAUTION

DO NOT TURN VACUUM "ON" WITHOUT ATTACHING VACUUM HOSE TO VACUUM OUTLET.

REMOVAL OF TOP LID FROM VACUUM HEAD ASSEMBLY

This equipment is designed to be service-free. If the filter element becomes damaged, leaking dust could collect inside the vacuum head assembly. The top lid must then be removed to perform cleaning. When removal becomes necessary for cleaning or other service, follow the procedures described below.

1. Remove protective molding from the top edge of vacuum head assembly. Note: The molding is reusable and should be kept for re-installation.

2. Remove two mounting screws (self-tapping Phillips head screws) located above handles.
3. Loosen four large head screws (self-tapping Phillips head screws), attach wires to these screws and pull upward evenly.
4. Use a conventional vacuum cleaner to clean entire inside of vacuum head assembly.

INSTALLATION OF TOP LID TO VACUUM HEAD ASSEMBLY

Upon completion of the service work, install top lid according to the following procedure:

1. Unplug the unit before attempting service or maintenance work.
2. Carefully align two holes on the rim of top lid to two mounting holes and install top lid to vacuum head.
3. Fasten two mounting screws to secure top lid.
4. Tighten four large head screws.
5. Install protective molding to the top edge making sure that the two ends are located in the rear of vacuum head.

VACUUM HEAD TOP VIEW

(Top Cover Removed)

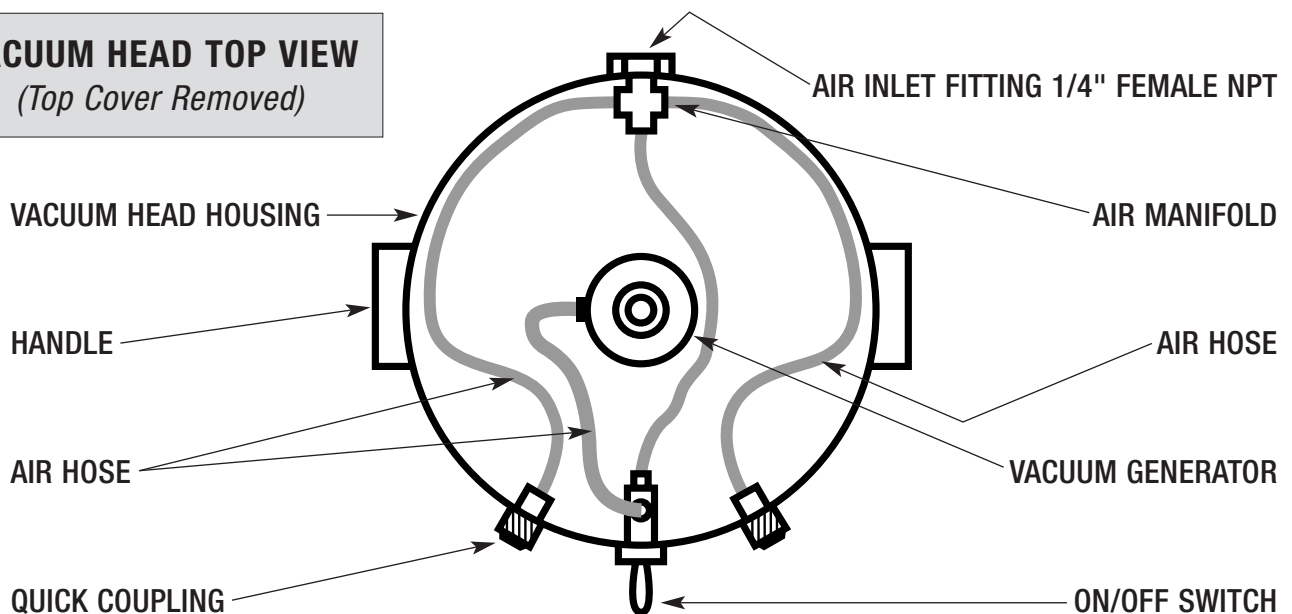

MACHINE PARTS LIST

| ITEM | PART NO. | DESCRIPTION |
|------|------------|---------------------------------------|
| 1 | Z102-B | Air Manifold, 1/4" NPT x 3 |
| 2 | Z9125-B | Hose Barb, 3/8" Hose |
| 3 | RBH38X34R | Air Hose to Q.C. |
| 4 | PET38X12 | Air Tube to Vacuum Generator |
| 5 | 26-150A | Vacuum Generator |
| 6 | 26-270 | Vacuum Outlet Assembly, Left |
| 7 | 27-218 | Rim Clamp |
| 8 | 27-175 | Cartridge Filter (New) |
| 9 | 27-381 | Axle Shaft 1/2" x 18" ZP |
| 10 | 11-161 | Wheel, 6" Heavy Duty Industrial |
| 11 | 27-384 | Wheel Cap, High Impact, 1/2" Ax |
| 12 | 26-721 | Hose Cuff 1-1/4" |
| 13 | 26-718 | Vacuum Hose, 1-1/4" I.D., Short Piece |
| 14 | Z9125-6B | Hose Barb, 1/4" NPT Threads |
| 15 | 26-726 | Hose Cuff Reducer, Blue |
| 16 | 26-700 | Hose Assembly, Complete, 16' |
| 16A | 26-711 | Vacuum Hose, 1-1/4" I.D., Long Piece |
| 16B | 26-701 | Vacuum Hose, 1-1/4" I.D., per Foot |
| 17 | 26-725 | Hose Connector |
| 18 | 10-168 | Leg Support Ferrule |
| 19 | 26-300-BK | Base Assembly |
| 20 | 26-201S | Main Body Assembly, Stainless Steel |
| 21 | PEC14 | Seal Ring |
| 22 | 26-260 | Vacuum Outlet Assembly, Right |
| 23 | 26-751 | Air Hose, 3/8" I.D. |
| 23A | PET14X38 | Hose 3/8" O.D., per Foot |
| 24 | 26-111S | Vacuum Head, Stainless Steel |
| 25 | NP-HAND572 | Handle, Chrome Plated |
| 26 | QCF38HB | Quick Coupler, 3/8" Female |
| | QCM38HB | Quick Coupler, 3/8" Male |
| 27 | 26-141A | ON/OFF Valve Switch |
| 28 | 26-109 | Molding, Vacuum Head |
| 29 | 26-101 | Vacuum Head Cover |

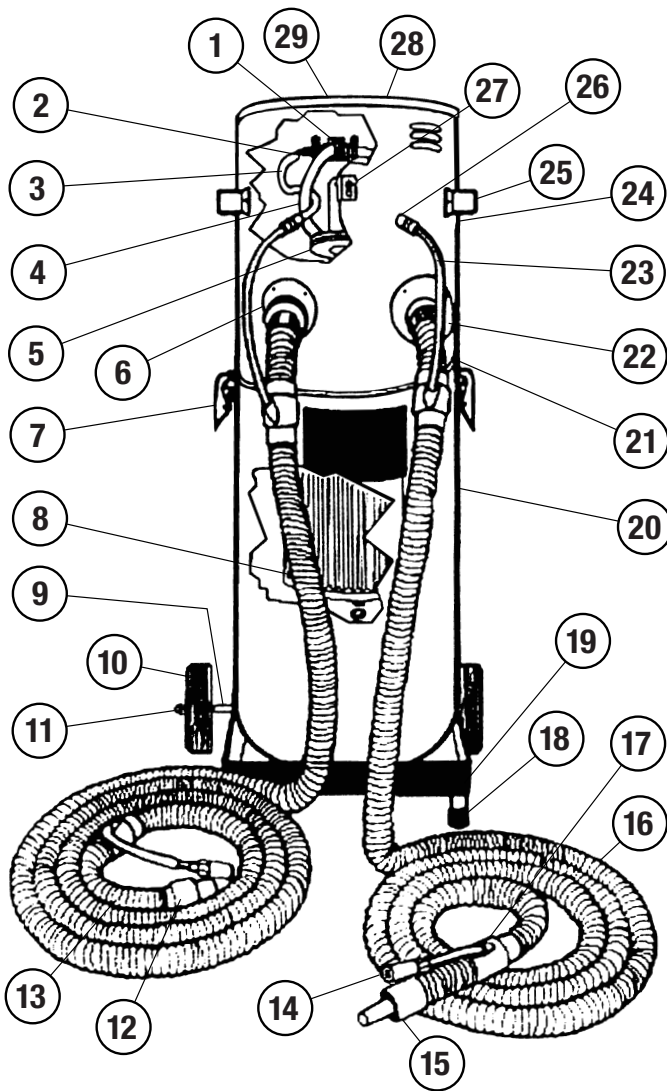

TECHNICAL SPECIFICATIONS – AUTOMATIC DUST EXTRACTION SYSTEM

| | |
|-------------------------------|---|
| Name | Air-Operated Dust Collector |
| Model No. | UR500VAC-A |
| Vacuum Generator | Dynabrade Model 64625, 8 Jets |
| Noise Level | 73 Decibels |
| Air Pressure | 80 to 150 PSIG (5.6 to 10.4 kg/cm ²) |
| Air Consumption | 20 CFM at 80 PSIG (570L/minute at 5.5 kg/cm ²) 30 CFM at 120 PSIG (850L/minute at 8.3 kg/cm ²) |
| Sealed Vacuum | 1.5 in Hg (520 mm water) at 80 PSIG (5.2 kg/cm ²) 2.0 in Hg (695 mm water) at 120 PSIG (8.3 kg/cm ²) |
| Free Flow | 420 CFM |
| Capacity | 10 Gallons/38 Liters |

| | |
|--|--|
| Filter | Cartridge Filter, 8" O.D. x 13.5" high |
| Filtration Area | 1,468 sq. in. |
| No. of Vacuum Outlets | 2 with Auto Shut-Off Hinged Covers |
| Standard Accessories | 2 Pieces of 1-1/4" I.D. x 18' Long Flexible Vacuum Hose with Built-In 3/8" I.D. Air Supply Tubing |
| Construction | Stainless Steel Body and Vacuum Head |
| Dust & Debris Collection | Plastic Bag, 5 Supplied |
| Shipping Size | 19" wide x 19" dia. x 44" high (48 cm wide x 48 cm dia., x 112 cm high) |
| Shipping Weight | 48 lbs. (21.8 Kg) |

DYNABRADE CUSTOMER SERVICE
US Consumers Call Toll-Free: 1-800-828-7333 • Canadian Consumers Call Toll-Free: 1-800-344-1488

US Consumers Call Toll-Free: 1-800-828-7333 • Canadian Consumers Call Toll-Free: 1-800-344-1488

DYNABRADE, INC.

www.dynabrade.com

8989 Sheridan Drive • Clarence, NY 14031-1490 • Phone: (716) 631-0100 • Fax: 716-631-2073 • International Fax: 716-631-2524

©DYNABRADE, INC., 2003

PRINTED IN USA

D04.06 Rev. 2 4/04

